

Heatsink type RE for modules.

Package details

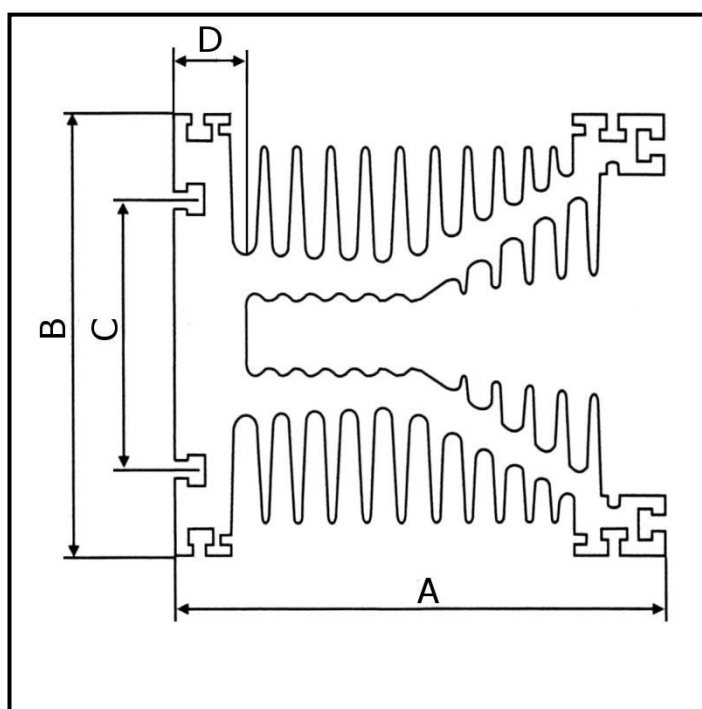

	A	B	C	D
		mm		
RE	136	126	80	-
RE1	136	126	93	19,5
RE2	146	130	112	29,5

For further package information, please contact Sales & Marketing Department.
All dimensions in mm, unless stated otherwise.
Do not scale.

Type RE Heatsink

KKRre, March 2012 version

CHARACTERISTICS

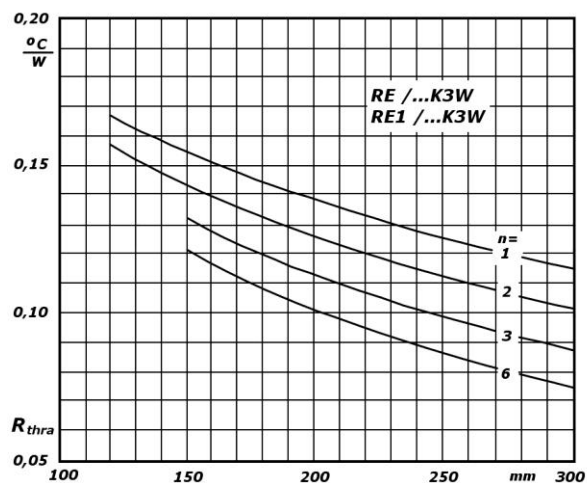

RE. Thermal resistance vs. length
n – number of elements on the heatsink

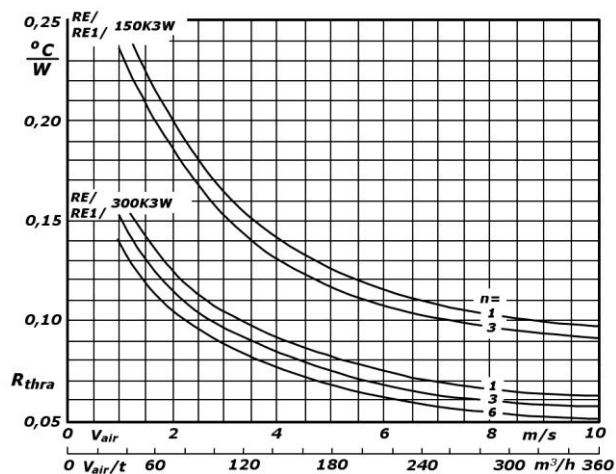

RE. Thermal resistance vs. air velocity and air flow
n – number of elements on the heatsink